

Diversified Installation Methods

The street lights are suitable for all the installation methods. Its standard bracket angle can be adjusted from 0-90 degrees. And it can also be installed on the square shape pole by simply adding an extra converter.

The standard bracket of the street light is based on 60mm round port. There are many different bracket converter prepared for the street light, such as round to square, 60-48mm, 60-80mm, etc.



\$70.00

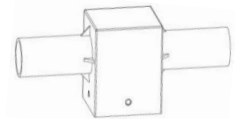

2 in 1 converter

\$81.00

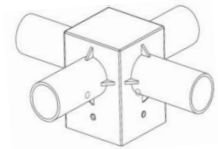

4 in 1 converter

\$66.00

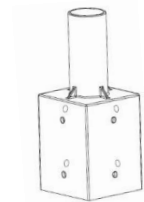

Round to square converter

\$48.00

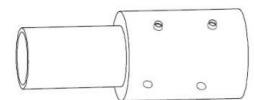

80-60mm converter

\$32.00

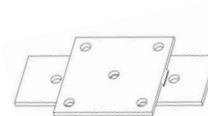

wall mount converter

\$48.00



60-40mm converter

\$34.00

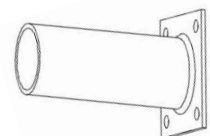

60mm to wall mount converter